

PCR019-1

SIZE $\phi 18\text{mm} \times 92.85\text{mm}$

CAPACITY Cup: 10.0mm

MATERIAL Sleeve: Aluminum / Cap&Base: PCR

Lomei

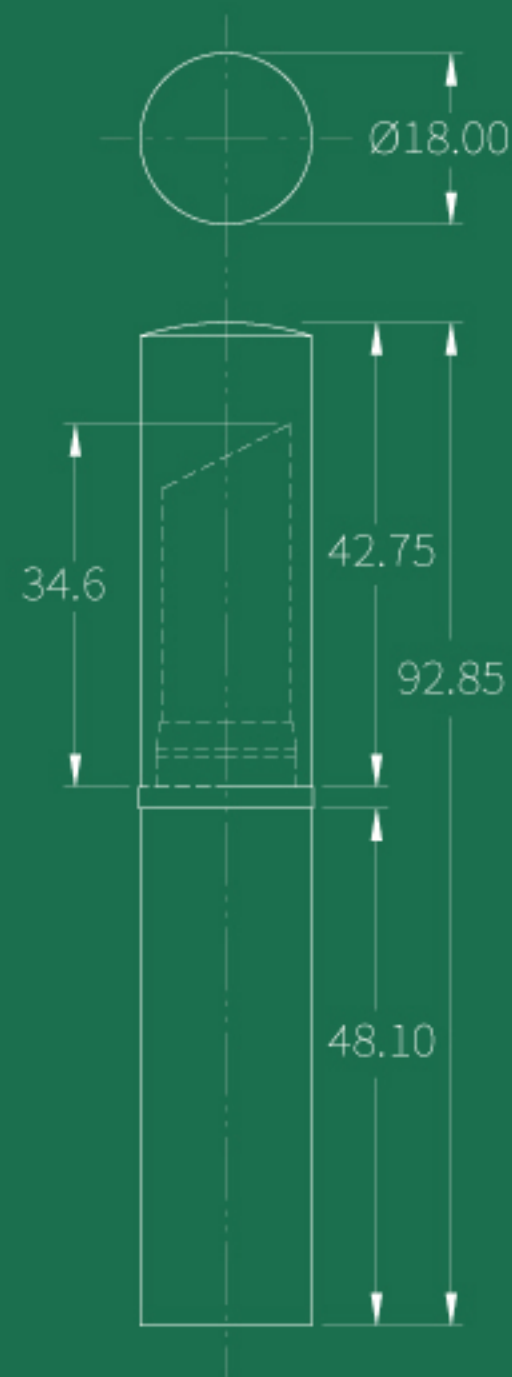

PCR2292

SIZE $\phi 22.1\text{mm} \times 74.8\text{mm}$

CAPACITY Cup: 12.1mm / 12.7mm (3.5g)

MATERIAL PCR

Lomei

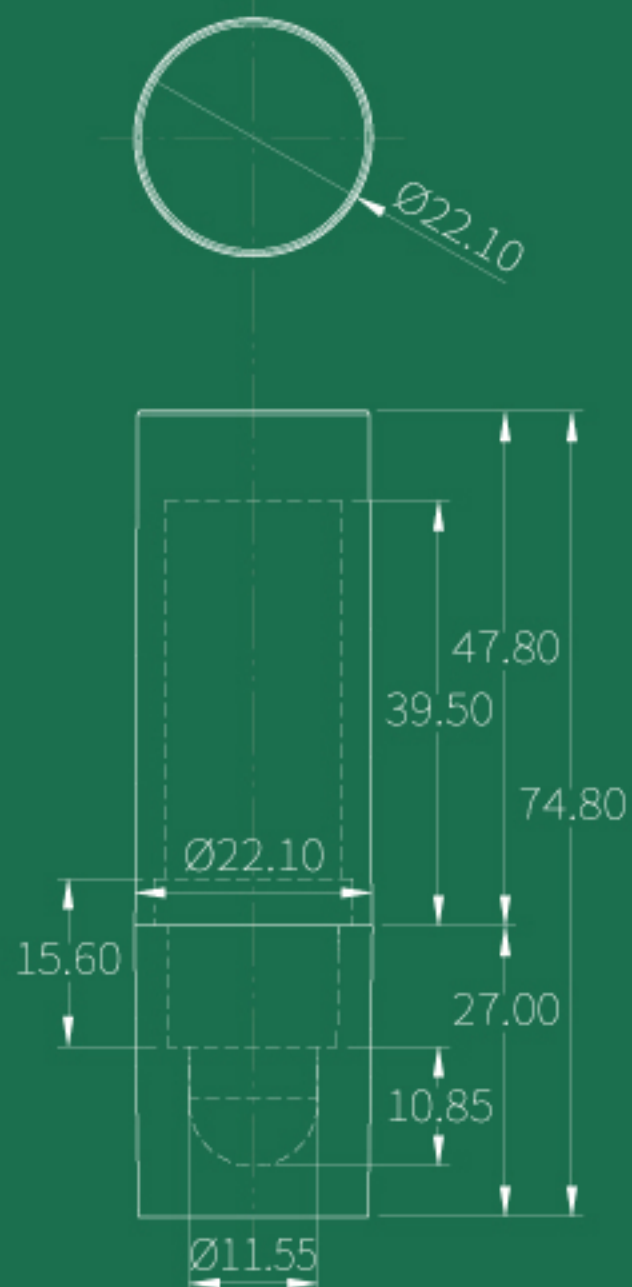

PCR029

SIZE 20.00mm × 20.00mm × 71.85mm

CAPACITY 3.5g

MATERIAL PCR

Lomei

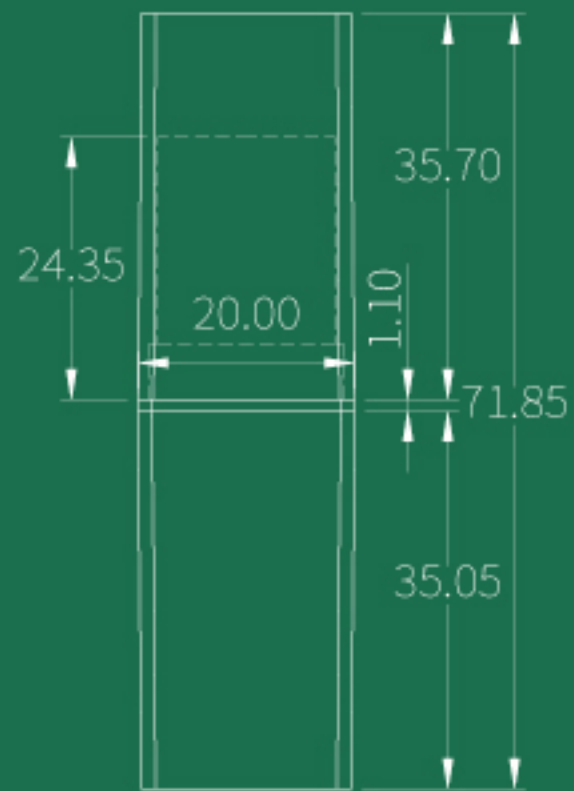
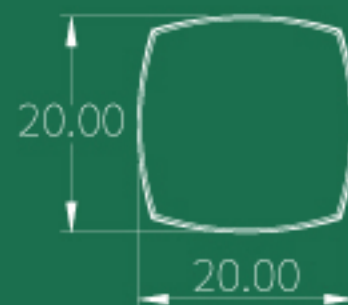

PCR789-1

SIZE 22.7mm × 22.7mm × 72.5mm

CAPACITY Cup: 12.1mm / 12.7mm (3.5g)

MATERIAL PCR

Lomei

