

EL01

SIZE $\phi 19.9 \text{ mm} \times 98.6 \text{ mm}$

CAPACITY 4.5g

MATERIAL Cap:AS+ABS/Bottle:PETG+PAPER/Stem:PP / Wiper:PE

Lomei

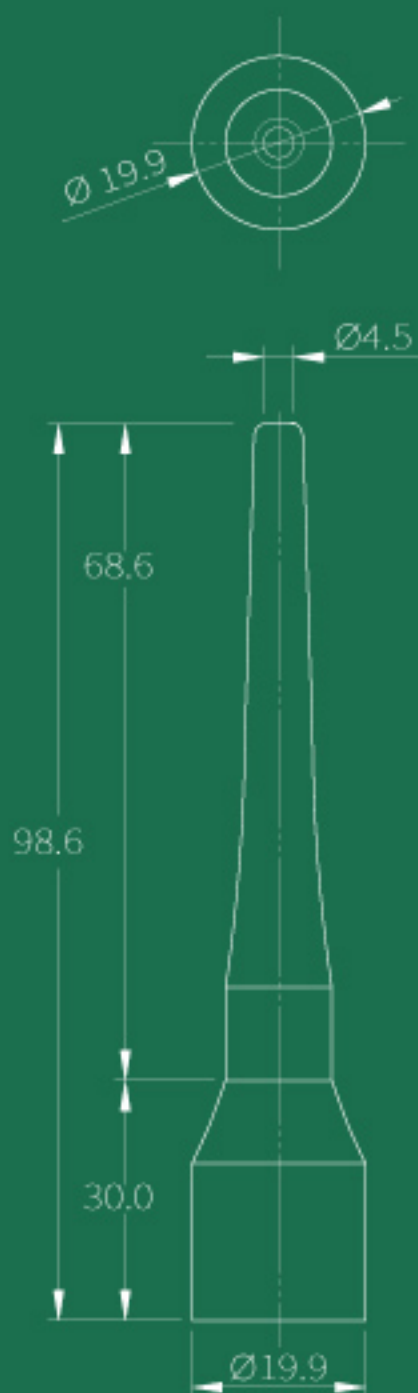

EL110

SIZE $\phi 15.3 \text{ mm} \times 84.9 \text{ mm}$

CAPACITY 3ml

MATERIAL Cap & Base : Paper/Bottle : PETG/Stem : PP / Wiper: PE

Lomei

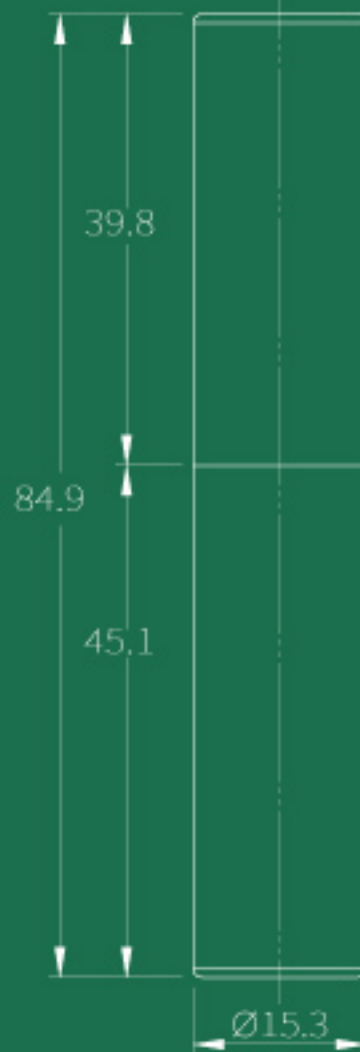

LG01

SIZE $\phi 17.0 \text{ mm} \times 97.0 \text{ mm}$

CAPACITY 8ml

MATERIAL Cap & Base : Paper/Bottle : PETG/Stem : PP/Wiper: PE

Lomei

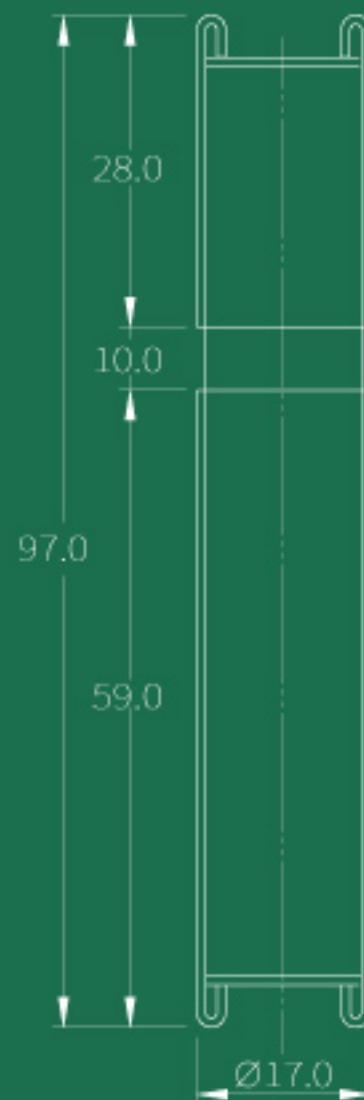

MA01

SIZE $\phi 17.0 \text{ mm} \times 130.0 \text{ mm}$

CAPACITY 12ml

MATERIAL Paper

Lomei

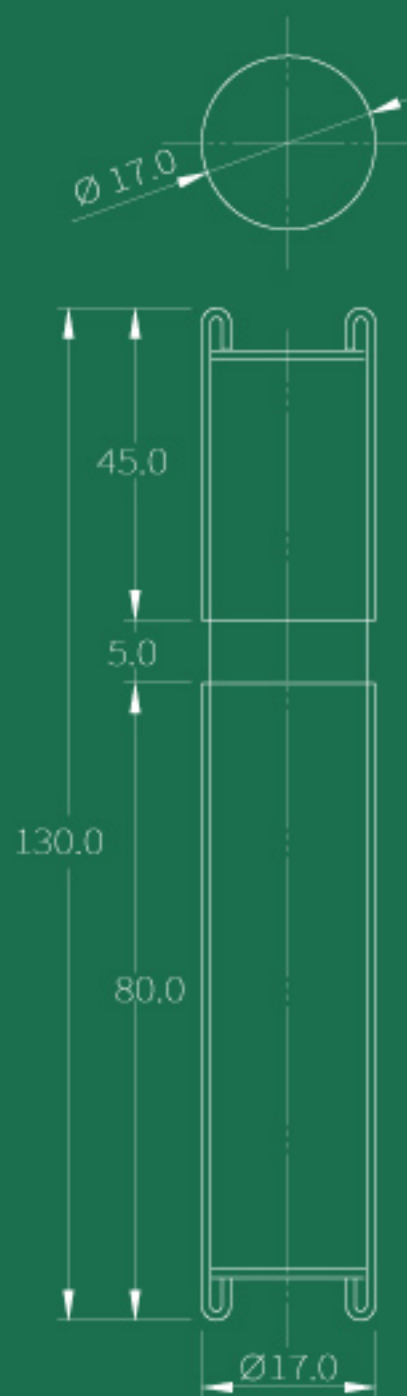

MA02

SIZE $\phi 17.0 \text{ mm} \times 117.0 \text{ mm}$

CAPACITY 12ml

MATERIAL Paper

Lomei

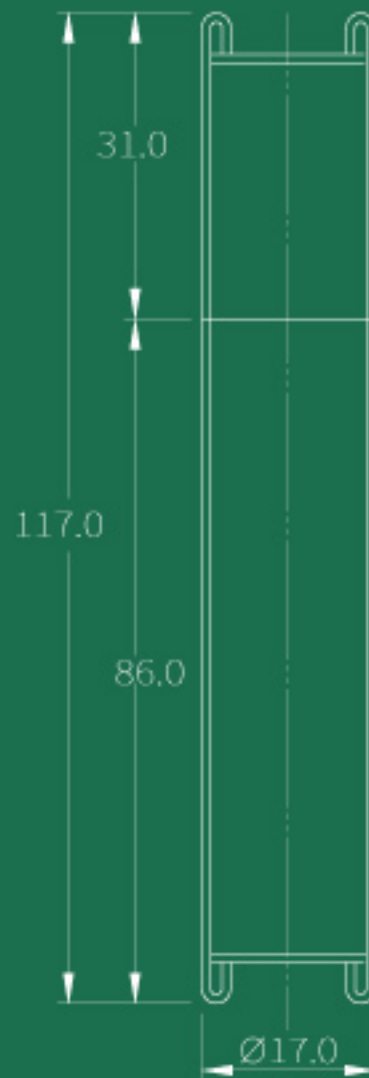

MA03

SIZE $\phi 17.0$ mm \times 114.0 mm

CAPACITY 8ml

MATERIAL Paper

Lomei

